

SCLC...

MaxiLock S

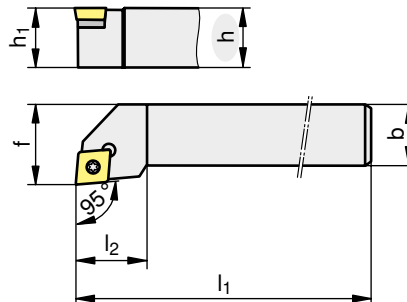
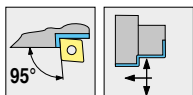

На изображении правостороннее исполнение

| h [mm] | Тип, обозначение | LNR | h ₁ [mm] | b [mm] | l ₁ [mm] | l ₂ [mm] | f [mm] | | |
|-----------|---------------------|---------|------------------------|-----------|------------------------|------------------------|-----------|-------------|-----|
| | | | | | | | | | |
| 8 | SCLCR 0808 D06 | R | 8 | 8 | 60 | 9 | 10 | CC.. 0602.. | E01 |
| 8 | SCLCL 0808 D06 | L | 8 | 8 | 60 | 9 | 10 | CC.. 0602.. | E01 |
| 10 | SCLCR 1010 E06 | R | 10 | 10 | 70 | 9 | 12 | CC.. 0602.. | E01 |
| 10 | SCLCL 1010 E06 | L | 10 | 10 | 70 | 9 | 12 | CC.. 0602.. | E01 |
| 12 | SCLCR 1212 F09 | R | 12 | 12 | 80 | 15 | 16 | CC.. 09T3.. | E02 |
| 12 | SCLCL 1212 F09 | L | 12 | 12 | 80 | 15 | 16 | CC.. 09T3.. | E02 |
| 16 | SCLCR 1616 H09 | R | 16 | 16 | 100 | 17 | 20 | CC.. 09T3.. | E03 |
| 16 | SCLCL 1616 H09 | L | 16 | 16 | 100 | 17 | 20 | CC.. 09T3.. | E03 |
| 20 | SCLCR 2020 K09 | R | 20 | 20 | 125 | 17 | 25 | CC.. 09T3.. | E03 |
| 20 | SCLCL 2020 K09 | L | 20 | 20 | 125 | 17 | 25 | CC.. 09T3.. | E03 |
| 16 | SCLCR 1616 H12 | R | 16 | 16 | 100 | 20 | 20 | CC.. 1204.. | E04 |
| 16 | SCLCL 1616 H12 | L | 16 | 16 | 100 | 20 | 20 | CC.. 1204.. | E04 |
| 20 | SCLCR 2020 K12 | R | 20 | 20 | 125 | 20 | 25 | CC.. 1204.. | E04 |
| 20 | SCLCL 2020 K12 | L | 20 | 20 | 125 | 20 | 25 | CC.. 1204.. | E04 |
| 25 | SCLCR 2525 M12 | R | 25 | 25 | 150 | 20 | 32 | CC.. 1204.. | E04 |
| 25 | SCLCL 2525 M12 | L | 25 | 25 | 150 | 20 | 32 | CC.. 1204.. | E04 |
| 32 | SCLCR 3225 P12 | R | 32 | 25 | 170 | 20 | 32 | CC.. 1204.. | E04 |
| 32 | SCLCL 3225 P12 | L | 32 | 25 | 170 | 20 | 32 | CC.. 1204.. | E04 |

Тоочение / Державки, наружная обработка

| | | | | | | |
|-----|-------|-------|-------|-------|------------|-------|
| | | | | | | |
| E01 | 24645 | | | | 8095010200 | 29280 |
| E02 | 24647 | | | | 8095010500 | 82271 |
| E03 | 24647 | 69216 | 69294 | 69293 | | 82756 |
| E04 | 54981 | 61006 | 69296 | 69293 | | 74208 |

| | | |
|------|---------|-----|
| | | |
| A303 | A82-A84 | A92 |