

W4420-L, coated

HPC2 end mills

F14



UN	HPC2 SF							
λ_s Var.	$\lambda_s = \begin{matrix} 17^\circ \\ 42^\circ \end{matrix}$	$\gamma_s = 14^\circ$	$d_s = f8$ $d_A = h6$					
<p>SCPP225</p>								

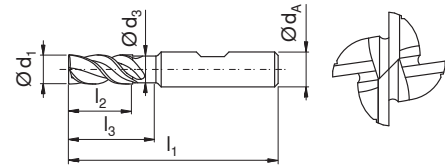

d_1 [mm]	Type, description	d_A [mm]	d_3 [mm]	l_1 [mm]	l_2 [mm]	l_3 [mm]	F [mm]	z	HB	Material
3.0	HPC2-SF.UN.4420.0300.L.Z4.F0010A.HB	6	2.8	57	8	13	0.1	4		W4420030341
4.0	HPC2-SF.UN.4420.0400.L.Z4.F0010A.HB	6	3.8	57	11	17	0.1	4		W4420040341
5.0	HPC2-SF.UN.4420.0500.L.Z4.F0010A.HB	6	4.8	57	13	19	0.1	4		W4420050341
6.0	HPC2-SF.UN.4420.0600.L.Z4.F0010A.HB	6	5.8	57	13	19	0.1	4		W4420060341
8.0	HPC2-SF.UN.4420.0800.L.Z4.F0020A.HB	8	7.7	63	21	25	0.2	4		W4420080341
10.0	HPC2-SF.UN.4420.1000.L.Z4.F0020A.HB	10	9.7	72	22	30	0.2	4		W4420100341
12.0	HPC2-SF.UN.4420.1200.L.Z4.F0030A.HB	12	11.6	83	26	36	0.3	4		W4420120341
16.0	HPC2-SF.UN.4420.1600.L.Z4.F0030A.HB	16	15.5	92	36	42	0.3	4		W4420160341
20.0	HPC2-SF.UN.4420.2000.L.Z4.F0030A.HB	20	19.5	104	41	52	0.3	4		W4420200341