

PSC

Hydraulic expansion chucks

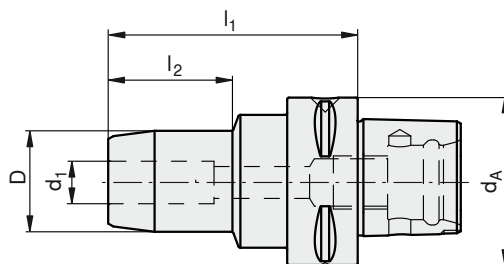
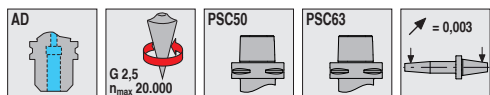

Type, description	d ₁ [mm]	l ₁ [mm]	l ₂ [mm]	d _A [mm]	D [mm]
PSC50-HD06-65	6	65	30	50	26
PSC50-HD08-65	8	65	30	50	28
PSC50-HD10-75	10	75	40	50	30
PSC50-HD12-80	12	80	40	50	32
PSC50-HD14-80	14	80	40	50	34
PSC50-HD16-85	16	85	46	50	38
PSC50-HD18-85	18	85	46	50	40
PSC50-HD20-85	20	85	46	50	42
PSC63-HD06-65	6	65	25	63	26
PSC63-HD08-65	8	65	25	63	28
PSC63-HD10-75	10	75	35	63	30
PSC63-HD12-80	12	80	40	63	32
PSC63-HD14-80	14	80	40	63	34
PSC63-HD16-85	16	85	46	63	38
PSC63-HD18-85	18	85	46	63	40
PSC63-HD20-85	20	85	46	63	42
PSC63-HD25-95	25	95	73	63	55
PSC63-HD32-100	32	100	78	63	63

⚠ For tools with shank to DIN 1835 A+B and DIN 6535 HA+HB
 Shank to DIN 6535 HE in connection with reduction sleeves

