

Adapters with threaded shank / Morse taper adapters with thread

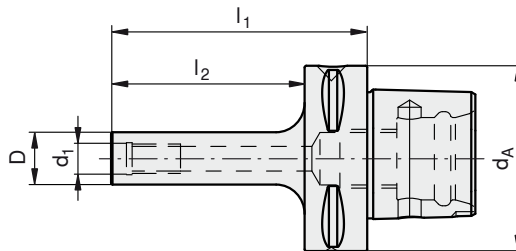

Type, description	d ₁ [mm]	l ₁ [mm]	l ₂ [mm]	d _A [mm]	D [mm]
PSC50-M8-70	8	70	50	50	13
PSC50-M10-80	10	80	60	50	18
PSC50-M12-80	12	80	60	50	21
PSC50-M16-80	16	80	60	50	29
PSC63-M8-70	8	70	48	63	13
PSC63-M10-90	10	90	68	63	18
PSC63-M12-100	12	100	78	63	21
PSC63-M16-100	16	100	78	63	29

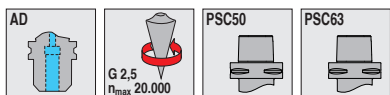
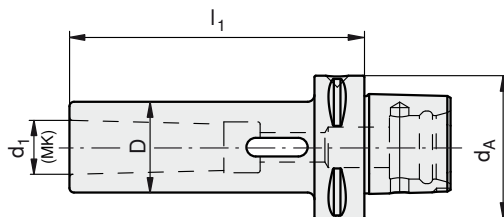
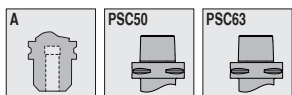

Type, description	d ₁ Morse taper [MK]	l ₁ [mm]	d _A [mm]	D [mm]
PSC50-MK2-110	2	110	50	32
PSC50-MK3-130	3	130	50	40
PSC50-MK4-150	4	150	50	48
PSC63-MK2-110	2	110	63	32
PSC63-MK3-130	3	130	63	40
PSC63-MK4-150	4	150	63	48

