

## Pulls studs DIN 7388 / reducers MK

G101

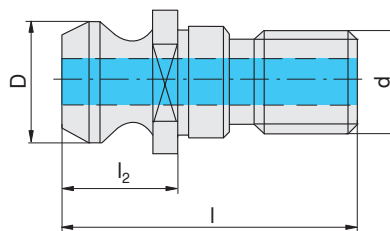

Type, description	SK	D [mm]	$l_2$ [mm]	l [mm]	Thread size
ISO/DIS7388-40.M16	40	22.5	16.40	41.26	M16
ISO/DIS7388-50.M24	50	37.0	25.55	65.50	M24

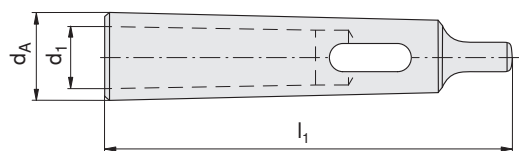

Type, description	$d_A$ Morse taper [MK]	$d_1$ Morse taper [MK]	$l_1$ [mm]
DIN2185.MK1-MK0-80	MK1	MK0	80
DIN2185.MK2-MK1-92	MK2	MK1	92
DIN2185.MK3-MK1-99	MK3	MK1	99
DIN2185.MK3-MK2-112	MK3	MK2	112
DIN2185.MK4-MK1-124	MK4	MK1	124
DIN2185.MK4-MK2-124	MK4	MK2	124
DIN2185.MK4-MK3-140	MK4	MK3	140
DIN2185.MK5-MK3-156	MK5	MK3	156
DIN2185.MK5-MK2-156	MK5	MK2	156
DIN2185.MK5-MK4-171	MK5	MK4	171